

# Kit 1053

**MAZDA 626**, 4-dr Sedan, 98-02

**MAZDA 626**, 5-dr Hatchback, 98-02

**MAZDA Capella**, 4-dr Sedan, 98-02

**FORD Telstar**, 4-dr Sedan, 98-02

480R  
754

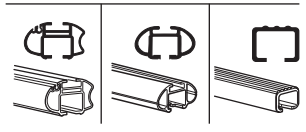
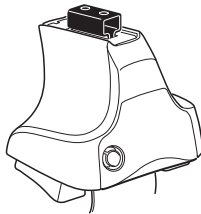

480

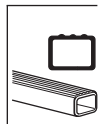
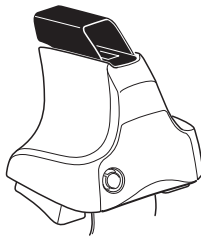

750

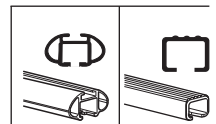
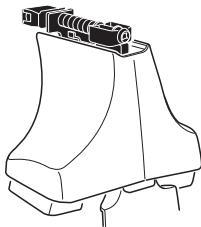

xx kg  
 xx lbs

7 kg  
 15,4 lbs

**Max. 75kg**  
**Max. 165 lbs**

80 km/h 50 Mph  
 130 km/h 80 Mph  
 40 km/h 25 Mph  
**km/h Mph**

**THULE**

**Kit XXXX**  
 instructions

x1  
 x4  
 x4  
 x4

**480R/754**

x1  
 x4  
 x4  
 x4

**480**

x1  
 x4  
 x4

**750**

x2 x2 x2 x4	x2	x2 x2 x4 x4	x2 x2	x2
----------------------	----	----------------------	----------	----

**153** x 2  
**155** x 2

**03** x 4

**RR** ↓ ↓ **FR**  
**FL** ↓ ↓ **RL**

**Kit**

**x 1**

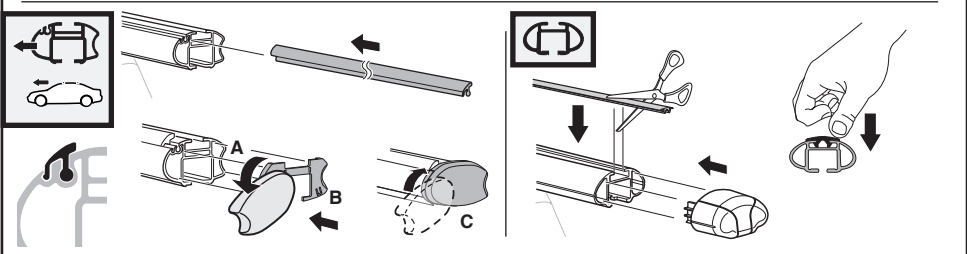
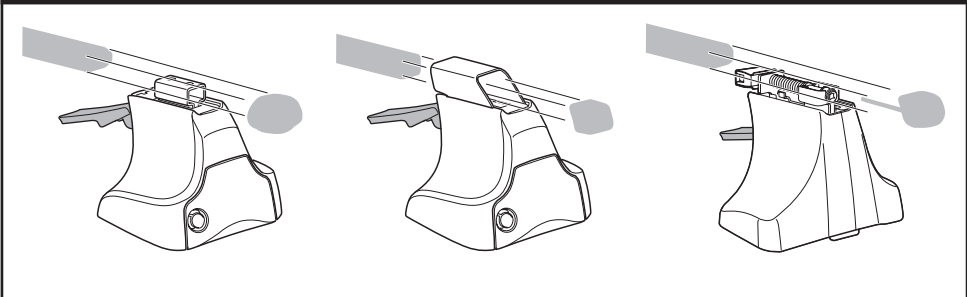

**3**

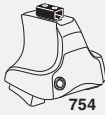

754

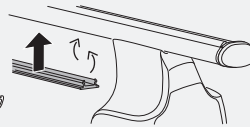
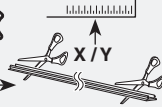

750



**1**

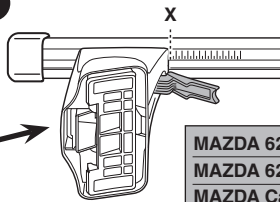
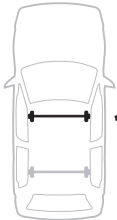

**2**

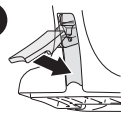

	X
<b>MAZDA 626, 4-dr Sedan, 98-02</b>	<b>35,5</b>
<b>MAZDA 626, 5-dr Hatchback, 98-02</b>	<b>36</b>
<b>MAZDA Capella, 4-dr Sedan, 98-02</b>	<b>35,5</b>
<b>FORD Telstar, 4-dr Sedan, 98-02</b>	<b>35,5</b>

**1**

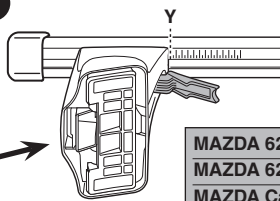
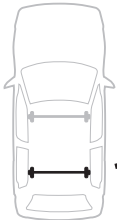

**2**

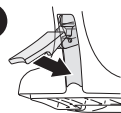

	Y
<b>MAZDA 626, 4-dr Sedan, 98-02</b>	<b>33</b>
<b>MAZDA 626, 5-dr Hatchback, 98-02</b>	<b>33</b>
<b>MAZDA Capella, 4-dr Sedan, 98-02</b>	<b>33</b>
<b>FORD Telstar, 4-dr Sedan, 98-02</b>	<b>33</b>



480R



480

**1**

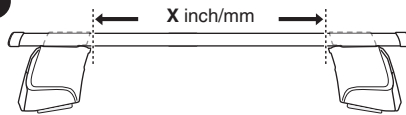

**2**

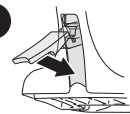

	X inch	X mm
<b>MAZDA 626, 4-dr Sedan, 98-02</b>	<b>39 5/8"</b>	<b>1006 mm</b>
<b>MAZDA 626, 5-dr Hatchback, 98-02</b>	<b>39 3/4"</b>	<b>1011 mm</b>
<b>MAZDA Capella, 4-dr Sedan, 98-02</b>	<b>39 5/8"</b>	<b>1006 mm</b>
<b>FORD Telstar, 4-dr Sedan, 98-02</b>	<b>39 5/8"</b>	<b>1006 mm</b>

**1**

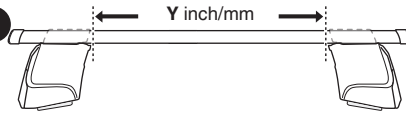

**2**

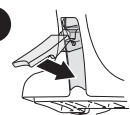

	Y inch	Y mm
<b>MAZDA 626, 4-dr Sedan, 98-02</b>	<b>38 5/8"</b>	<b>981 mm</b>
<b>MAZDA 626, 5-dr Hatchback, 98-02</b>	<b>38 5/8"</b>	<b>981 mm</b>
<b>MAZDA Capella, 4-dr Sedan, 98-02</b>	<b>38 5/8"</b>	<b>981 mm</b>
<b>FORD Telstar, 4-dr Sedan, 98-02</b>	<b>38 5/8"</b>	<b>981 mm</b>

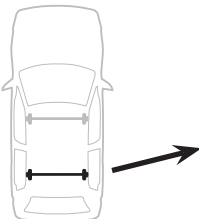

# 4

MAZDA 626, 4-dr Sedan, 98-02

MAZDA 626, 5-dr Hatchback, 98-02

MAZDA Capella, 4-dr Sedan, 98-02

FORD Telstar, 4-dr Sedan, 98-02

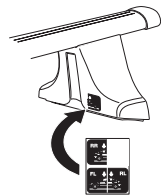
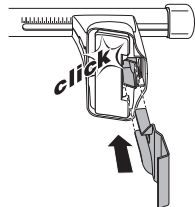
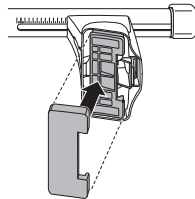
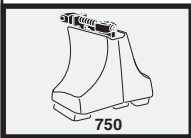
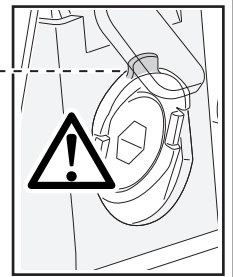
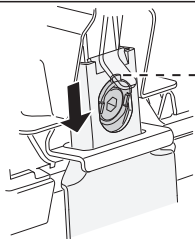
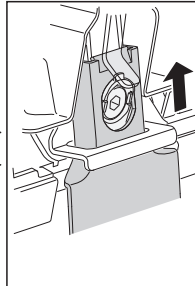
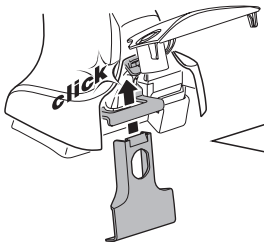
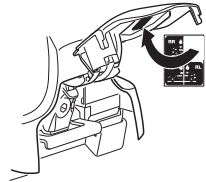
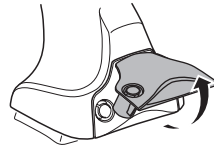
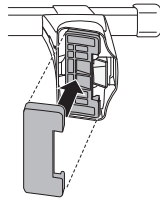
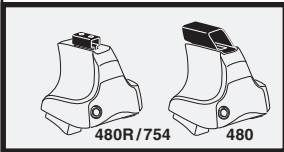
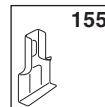
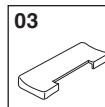
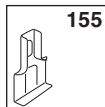
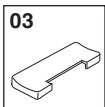
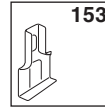
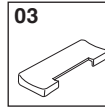
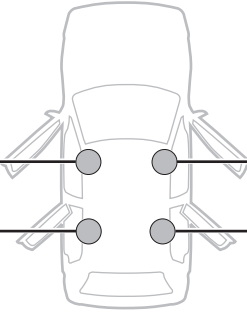
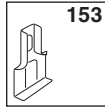
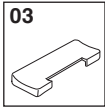

5

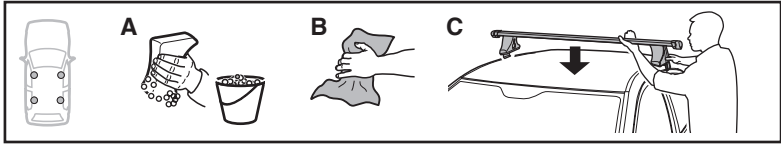

	X mm	Y mm	X inch	Y inch
<b>MAZDA 626, 4-dr Sedan, 98-02</b>	230 mm	700 mm	9"	27 1/2"
<b>MAZDA 626, 5-dr Hatchback, 98-02</b>	230 mm	700 mm	9"	27 1/2"
<b>MAZDA Capella, 4-dr Sedan, 98-02</b>	230 mm	700 mm	9"	27 1/2"
<b>FORD Telstar, 4-dr Sedan, 98-02</b>	230 mm	700 mm	9"	27 1/2"

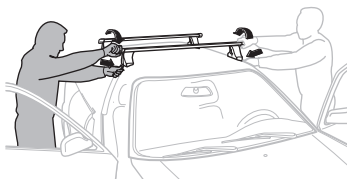
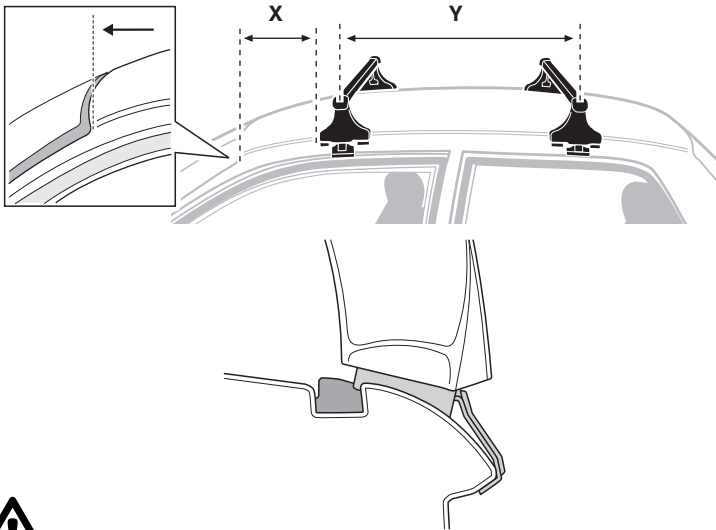

**GB/US** Tighten alternately

**D** Die Schrauben abwechselnd anziehen

**F** Serrer alternativement chaque côté

**NL** Afwisselend aan de linker- en de rechterkant aandraaien

**I** Alternare il serraggio delle viti

**E** Apretar alternativamente

**PT** Aperte alternadamente

**S** Dra åt växelvis

**FIN** Kierrä vuorotellen

**EST** Pinguldage vaheldumisi

**LAT** Pieveļciet pamišus

**LIT** Užsukinėkite pakaitomis

**PL** Śruby dokręcaj naprzemiennie

**RU** Затягивайте попеременно

**CZ** Pokręťta bagażníka dokręcaj dokręcaj naprzemiennie.

**SK** Doťahujte striedavo

**SLO** Privijajte izmenično.

**HR** Naizmjenično zategnite

**HU** Egymástól függetlenül szorítandó

**GR** Σφίγγετε εναλλάξ

**TR** Dönüşümlü sıkın

**中文** 交替拧紧

**한국어** 번갈아 가며 조이십시오.

**日本語** 交互に締め付けてください。

**ไทย** ชันโนแบบสลับ

6



480R/754



480

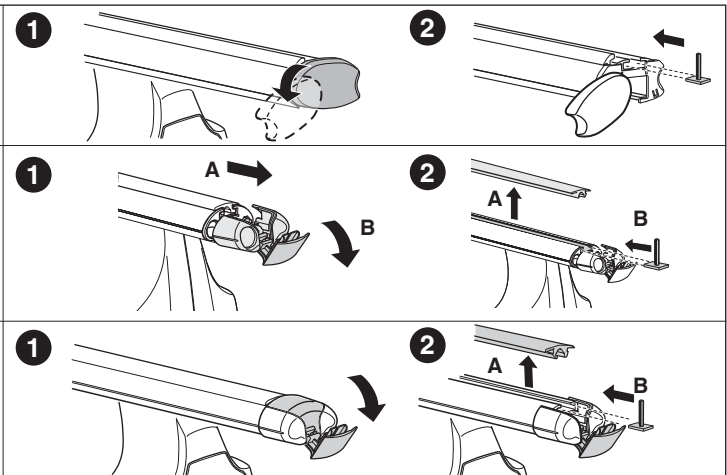
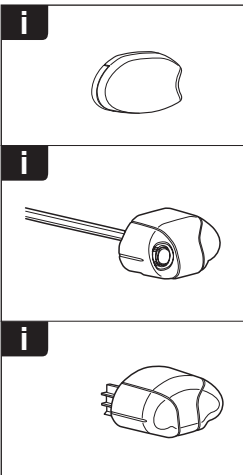
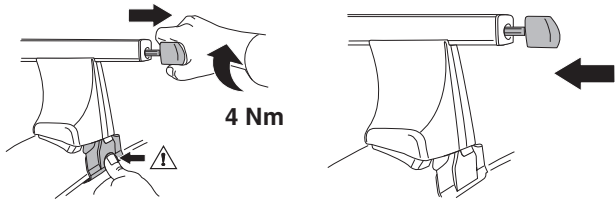
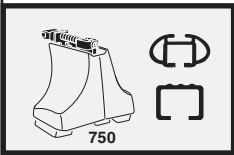
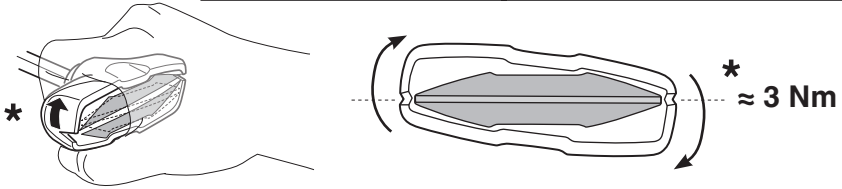
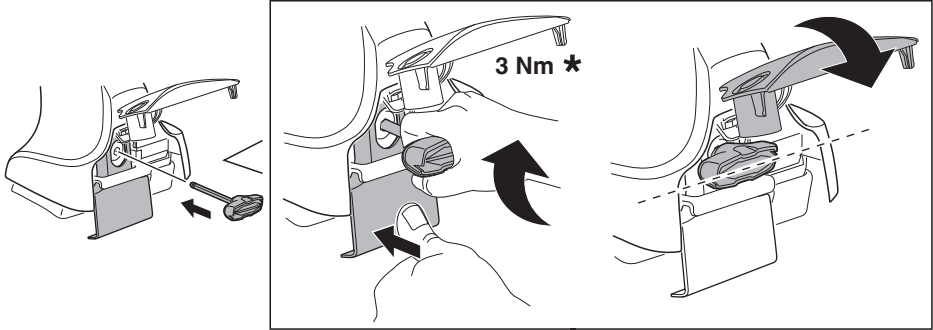

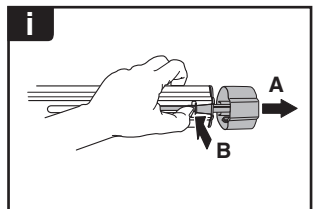
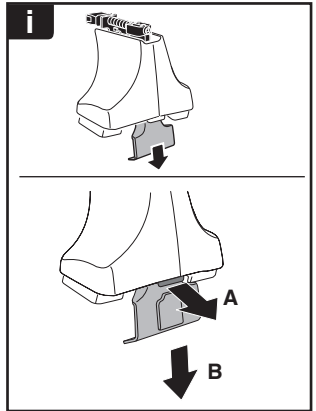
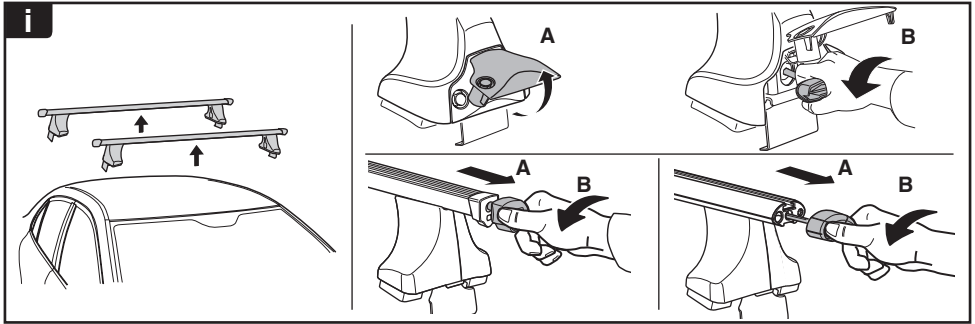

**THULE**  
SWEDEN  
**ONE  
KEY  
SYSTEM**



		(x4)
		(x6)
		(x8)
NA		(x10)
EUR		(x12)
ASIA		(x12)

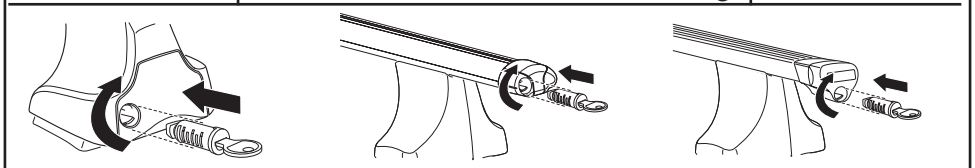

WW ▶ Thule Sweden AB, Box 69, 330 33 Hillerstorp, SWEDEN  
NA ▶ Thule Inc., 42 Silvermine Road, Seymour, Connecticut 06483, USA

info@thule.com  
customer.service@thule.com

www.thule.com