



PBS-2R Bike Stand

Assembly Option 1

Stores Bikes in Same Direction

The PBS-2R HAS TWO DIFFERENT ASSEMBLY OPTIONS. MAKE SURE YOU CHOOSE WHICH ONE YOU PREFER BEFORE ASSEMBLING THE BIKE STAND.

Parts Included

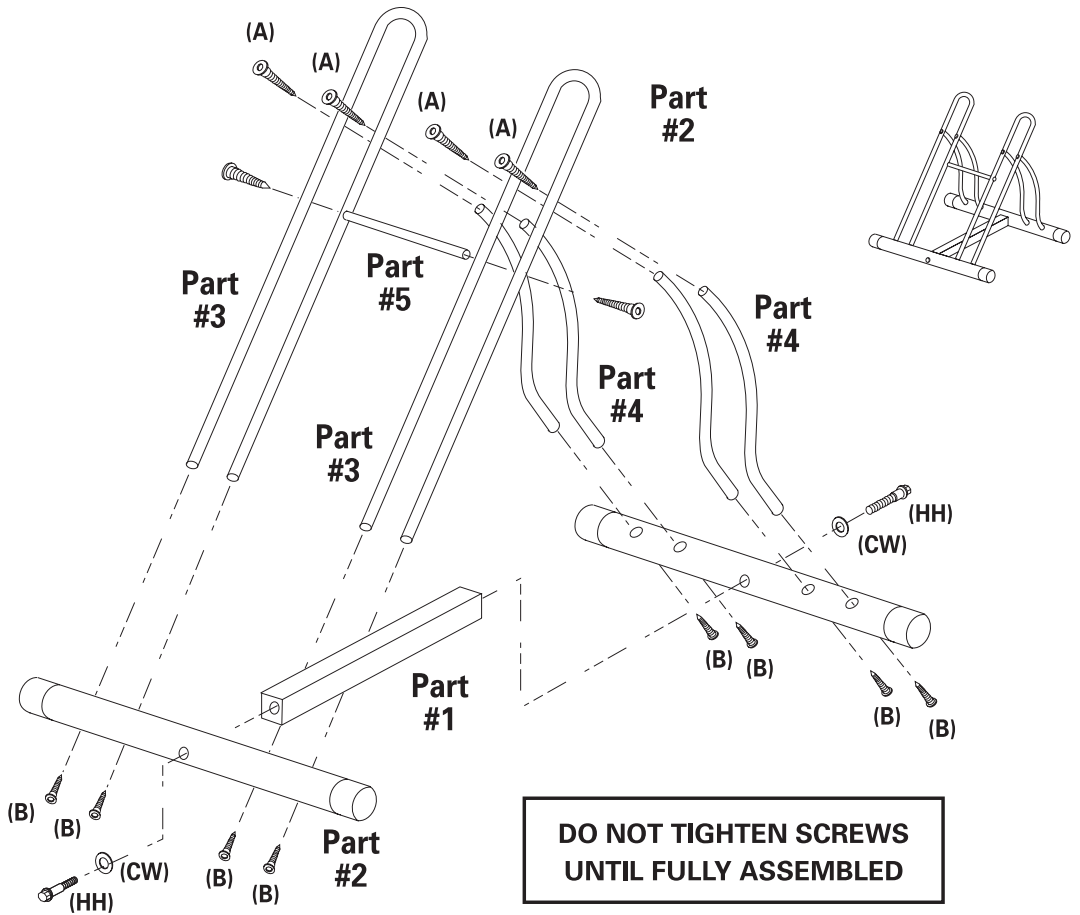
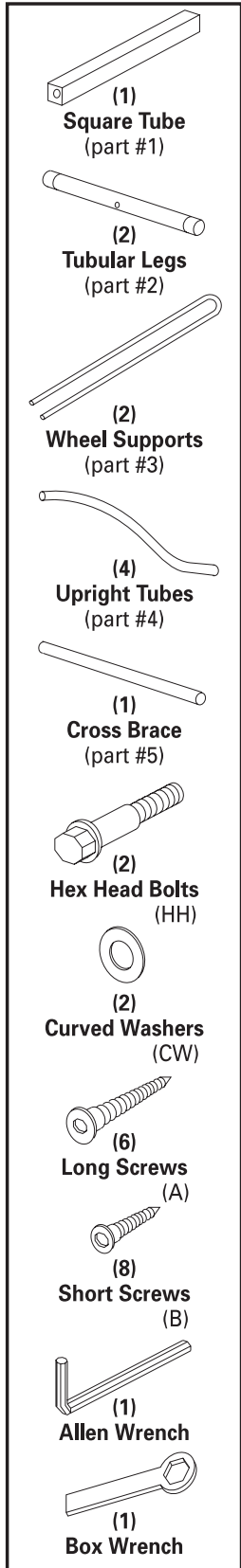

1. Attach the two **tubular legs** Part #2 to the **square tube** Part #1 with long hex head bolts and curved washers.
2. Insert two of the **Upright Tubes** Part #4 into the **Tubular legs** Part #2 and secure with two short screws; then connect the **wheel supports** Part #3 to **tubular legs** with two short screws. Use two long screws to attach upper portion of **upright tubes** to wheel supports. Repeat for the other half of the bike stand.
3. Connect the **wheel support** together using cross brace part #5 using long screws.

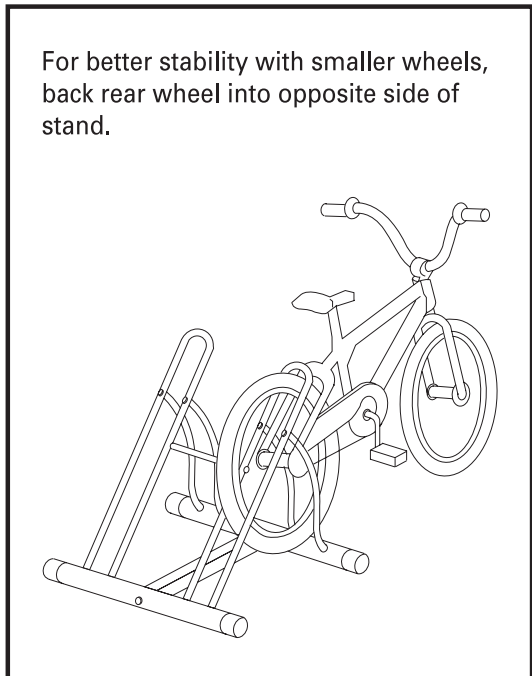
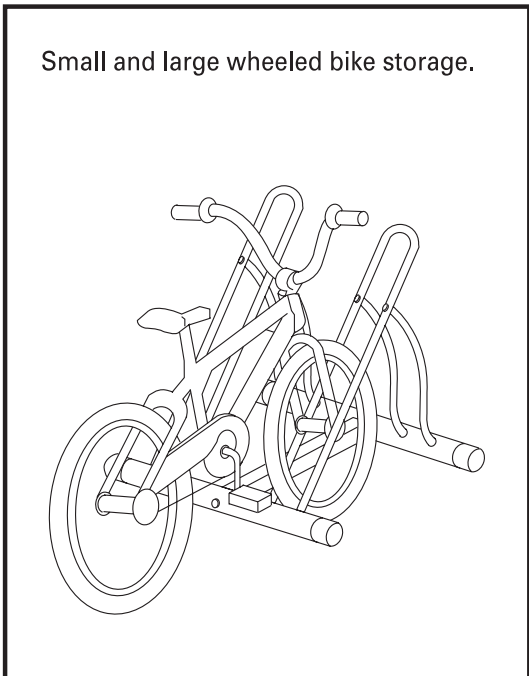



PBS-2R Bike Stand

Assembly Option 2
Store Bikes in Opposite Direction

The PBS-2R HAS TWO DIFFERENT ASSEMBLY OPTIONS. MAKE SURE YOU CHOOSE WHICH ONE YOU PREFER BEFORE ASSEMBLING THE BIKE STAND.

Parts Included

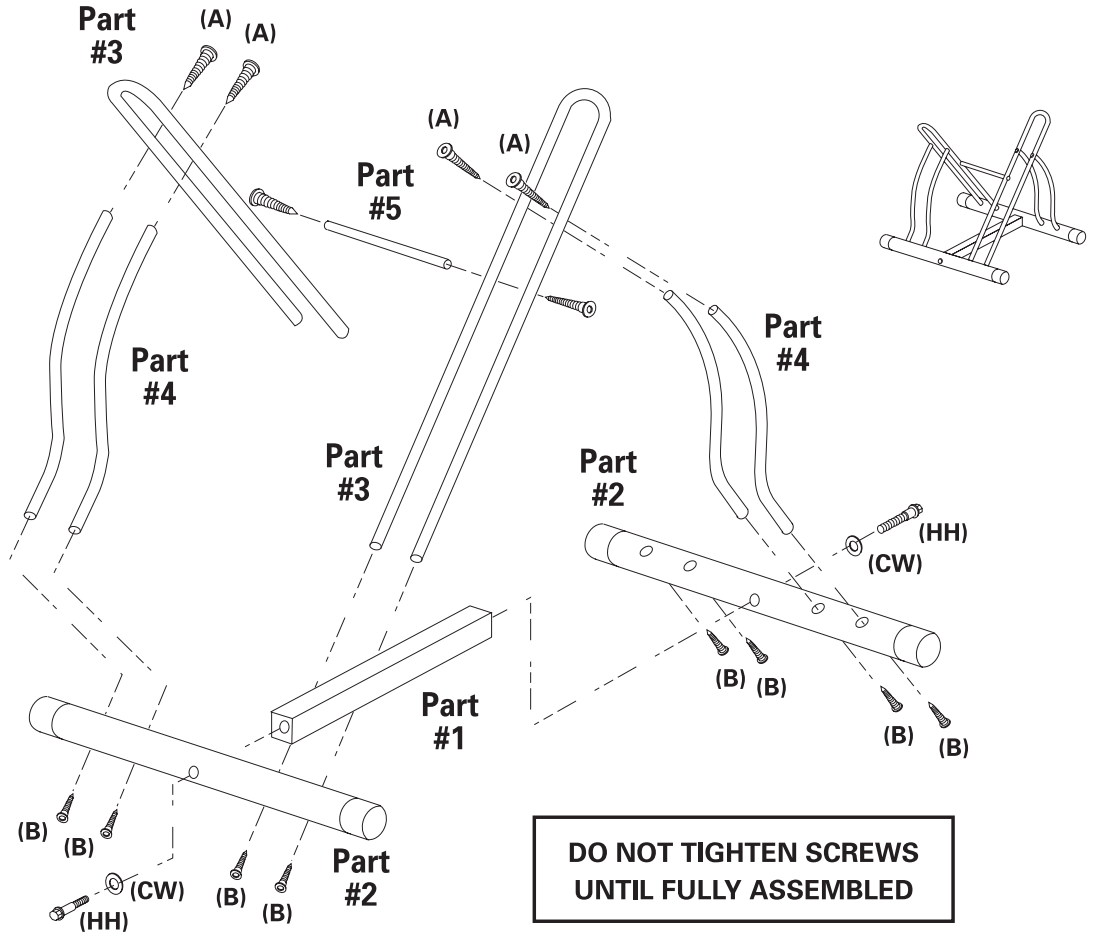
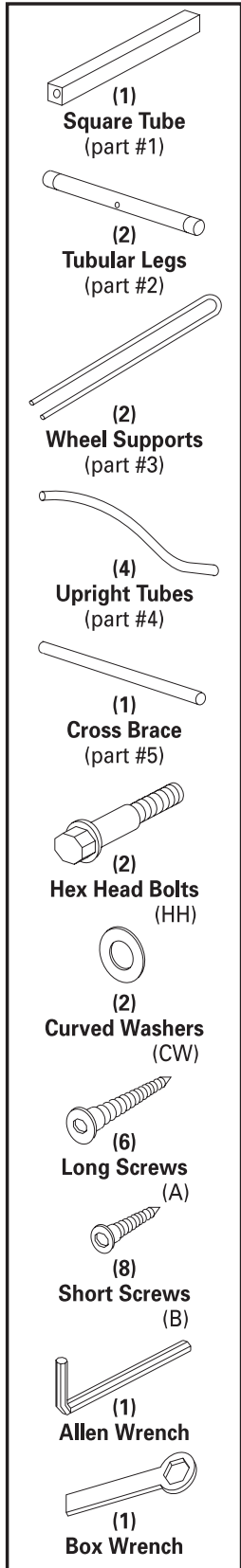

1. Attach the two **tubular legs** Part #2 to the **square tube** Part #1 with long hex head bolts and curved washers.
2. Insert two of the upright tubes part #4 into one of the tubular legs part #2 and secure with two short screws; then connect the wheel supports part #3 to tubular leg with two short screws. Use two long screws to attach upper portion of upright tubes to wheel supports. Put remaining upright tubes on opposite tubular leg and repeat assembly above for the other half of the bike stand.
3. Connect the **wheel support** together using cross brace part #5 using long screws.

